

Thrust Ball Bearing

51300 Series-51315

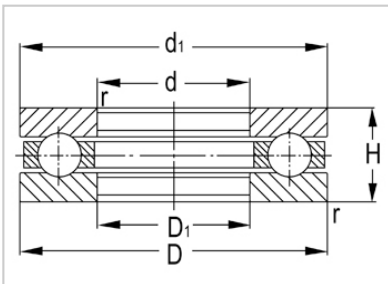

Designation	51315
Principal Dimensions(mm)	
d	75
D	135
T	44
Basic Load Ratings(KN)	
Dynamic(Cr)	162
Static(Cor)	380
Limited Speed(rpm)	
Grease	1100
Oil	1700
Weight (kg)	2.58

Luoyang Auto Bearing Co.,Ltd-Tel:0598-3607100-Email:moore@lyautobearing.com-http://www.auto-bearing.com